

SERIE XBS

3.1.58.

CODICE DI ORDINAZIONE / DECODING

3.1.58 . XXX . 0 . 0 . 0 . 0 . 0

DIN
5 4 8 2

XBS 11
XBS 16
XBS 22
XBS 28
XBS 32

Pompa ad Ingranaggi
Gear Pump



CILINDRATA/DISPLACEMENT

CODICE BASE/BASIC CODE

CARATTERISTICHE E DATI TECNICI / SPECIFICATIONS AND TECHNICAL DATA

TIPO TYPE	CODICE CODE	CILINDRATA DISPLACEMENT cm ³ /rev.	A mm	B mm	ASPIRAZIONE INLET	MANDATA OUTLET	PESO WEIGHT kg
XBS 11	3.1.58.011.0.0.0.0	11.5	103.5	143.5	1/2" G	1/2" G	5.5
XBS 16	3.1.58.016.0.0.0.0	16.4	111	151	1/2" G	1/2" G	5.85
XBS 22	3.1.58.022.0.0.0.0	20.5	117.5	157.5	1/2" G	1/2" G	6.2
XBS 28	3.1.58.028.0.0.0.0	28.6	111.3	170.3	3/4" G	3/4" G	6.6
XBS 32	3.1.58.032.0.0.0.0	32.6	117.5	176.5	3/4" G	3/4" G	7

KIT ACCOPPIAMENTO POSTERIORE
REAR MOUNTING KIT

2.05.P604.0000

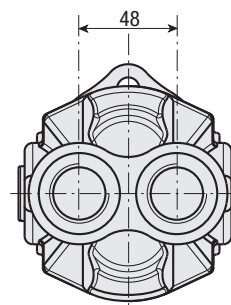
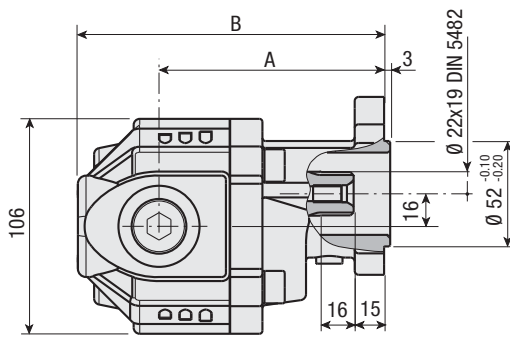
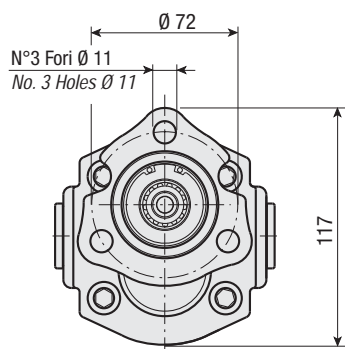

DATI TECNICI / TECHNICAL DATA

ESEMPIO CICLI LAVORO / EXAMPLE OF WORKING CYCLES

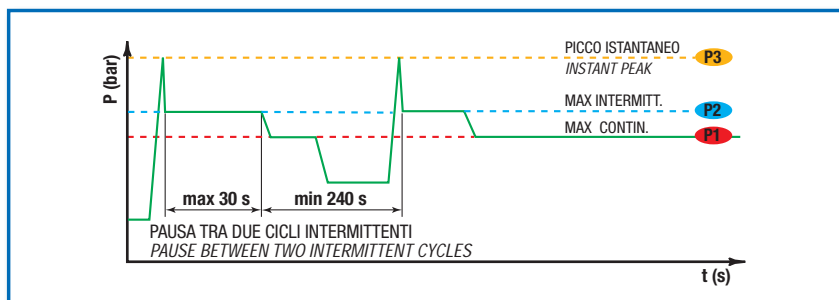

Pressione d'aspirazione: Inlet pressure:	0.7 ÷ 1.5 bar (assoluti/absolute)
Campo viscosità lavoro: Operating viscosity range:	12 ÷ 100 cSt
Temperatura fluido °C (t): Fluid temperature °C (t):	-10° + 80° C

Pressione Lavoro Working Press. P2	Contaminazione / Contamination		Filtro / Filter βx = 75
	NAS 1638	ISO 4406	
≤ 200 bar	12	21/18	40 μm
≥ 200 bar	11	20/17	25 μm

◀ **FILTRAZIONE CONSIGLIATA (ritorno o mandata)**
RECOMMENDED FILTERING (return or outlet)

TIPO / TYPE			XBS11	XBS16	XBS22	XBS28	XBS32
Cilindrata Displacement	Vg	cm ³ /n cm ³ /rev.	11.5	16.4	20.5	28.7	32.6
Pressione massima continua Max continuous operating pressure	P1	bar	280	280	260	220	190
Pressione massima intermittente Max intermitt. operat. press.	(max 30 s) P2		310	300	280	250	210
Pressione massima di picco Max peak pressure	(≤ 0.1 s) P3		320	310	290	260	220
Velocità massima intermittente Max intermittent speed	(P ≤ 20 bar) n3	n/min r.p.m.	2700	2700	2700	2700	2700
Velocità massima continua Max continuous speed	(≤ P1) n1		2200	2200	2000	2000	2000
Velocità minima intermittente Min intermittent speed	(≤ P2 x 0.5) (max 30 s) n4		450	450	450	450	450

DIAGRAMMI / DIAGRAMS

RILIEVI ESEGUITI CON OLIO ISO VG 46 A 50° C (ν = 30 cSt)
THE ABOVE SPECIFICATIONS REFER TO OIL TYPE ISO VG 46 AT 50° C (ν = 30 cSt)

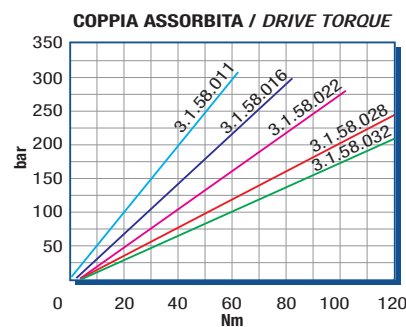
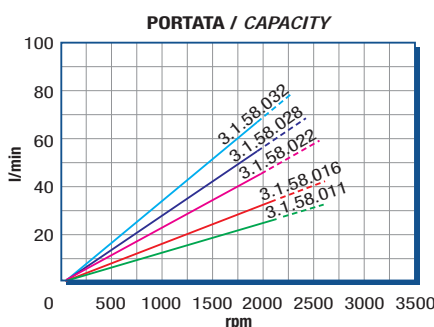
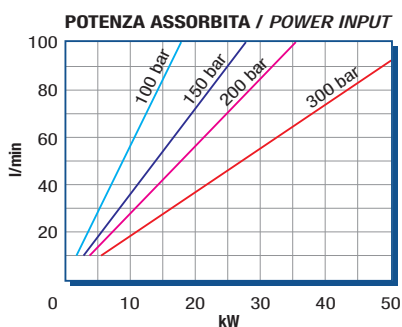

ROTAZIONE POMPA / PUMP ROTATION

SINISTRA
ANTI-CLOCKWISE

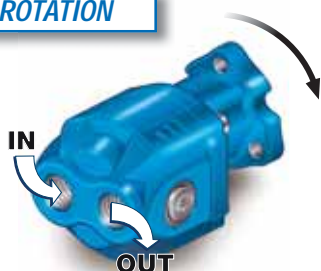

DESTRA
CLOCKWISE

