

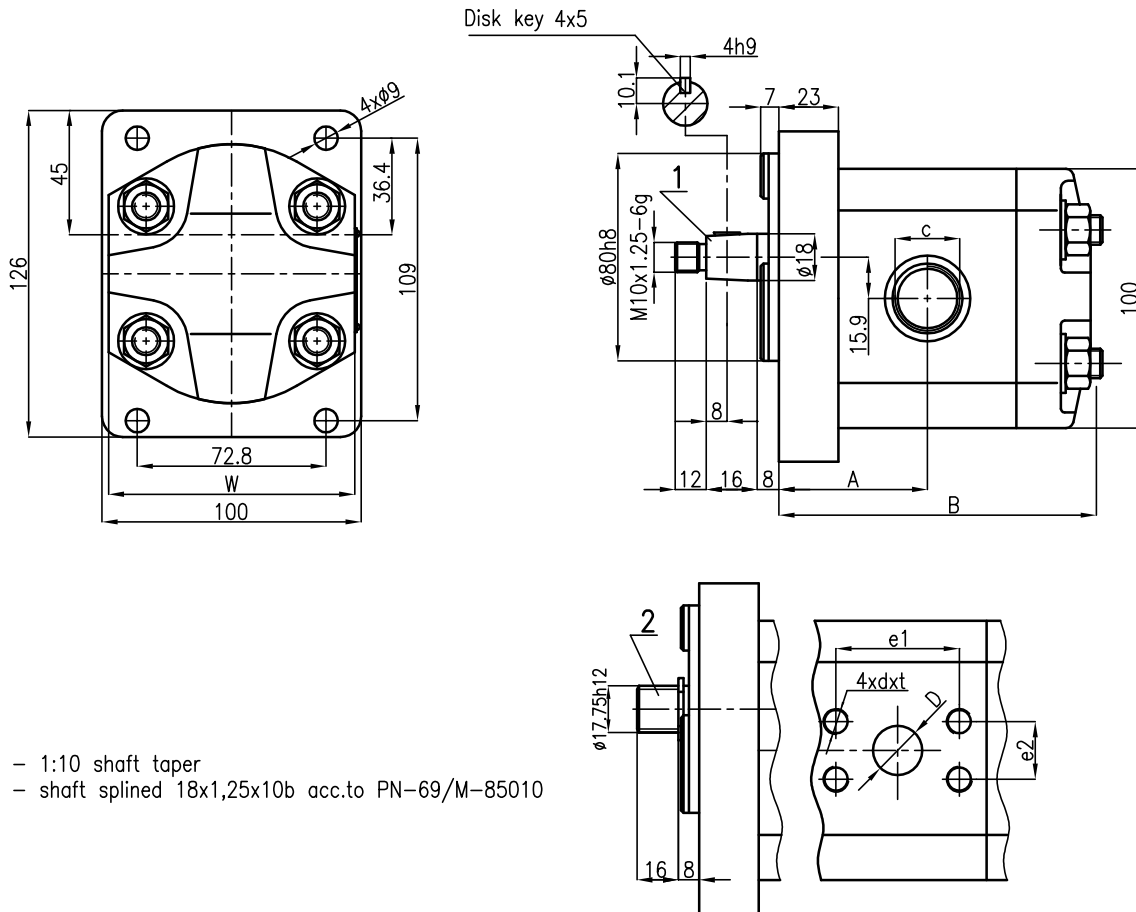

# PZ3-II-1 technical drawing



Geometric displacement ccm/rot	Pump designation	Dimension			Port flange ISO/DIS 6162				Port thread acc.to ISO 6149		Port flange ISO/DIS 6162					
		A	B	W	Inlet				c	c	Outlet					
					D	dxt	e1	e2			D	dxt	e1	e2		
4	PZ3-4/20-x-111	56	110.1	95	13	M8x17	38.1	17.5			13	M8x17	38.1	17.5		
	PZ3-4/20-x-211															
	PZ3-4/20-x-114					97					M20x1.5	M20x1.5				
	PZ3-4/20-x-214															
6.3	PZ3-6.3/20-x-111	57	114.1	95	19	M10x18	47.6	22.2			13	M8x17	38.1	17.5		
	PZ3-6.3/20-x-211															
	PZ3-6.3/20-x-114					97					M27x2	M22x1.5				
	PZ3-6.3/20-x-214															
10	PZ3-10/20-x-111	59.3	120.6	95	19	M10x18	47.6	22.2			13	M8x17	38.1	17.5		
	PZ3-10/20-x-211															
	PZ3-10/20-x-114					97					M27x2	M22x1.5				
	PZ3-10/20-x-214															
12.5	PZ3-12.5/16-x-111	61.5	125	95	25	M10x18	52	26.2			19	M10x18	47.6	22.2		
	PZ3-12.5/16-x-211															
	PZ3-12.5/16-x-114					97					M33x2	M27x2				
	PZ3-12.5/16-x-214															

x-direction of rotation (1-counter clockwise; 2-clockwise)