

N, X, PA, N2, X2, Y2

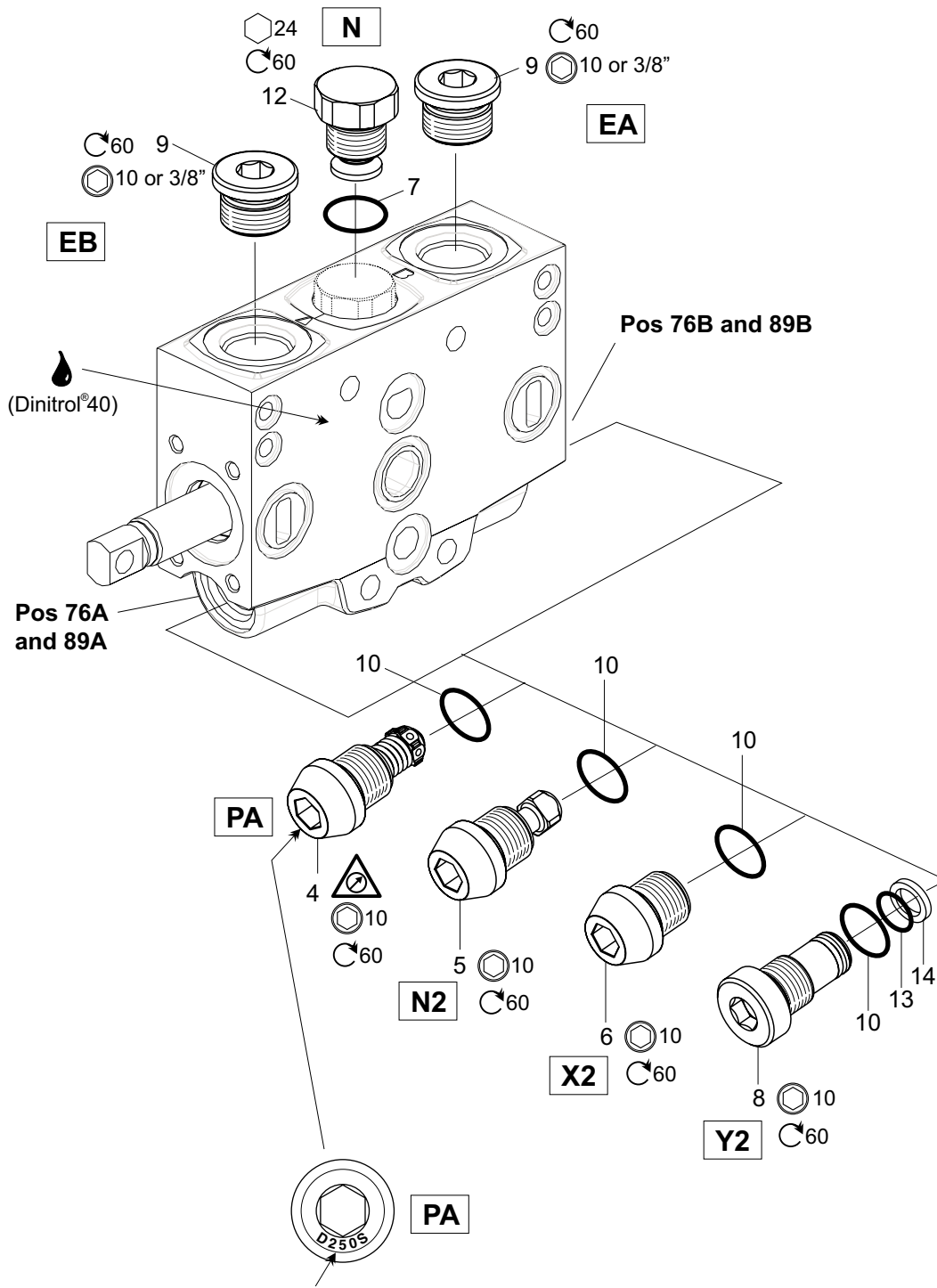

Design, Setting Pressure

- D = Std
- S = Variant A003
- U = Variant A007

See Customer Specification				
Code	Pos	Part	Description	Remarks / Items
N	66	398000K011	Supply check valve	12[7]
N	66	6760444	Seal kit	7 (5 pcs in kit)
EA, EB + G	60 + 04		Plug VST11/2EDCF, 'BSP'	9
EA, EB + U	60 + 04		Plug 10HP5ON-S, 'UNF'	9
N2	76A, 76B	393000K194	Load hold check valve	5[10]
X2	76A, 76B	393000K193	Cavity plugged (without check valve)	6[10]
Y2	76A, 76B	393000K195	Cavity plugged	8[10, 13, 14]
N2, X2	-	6760445	Seal kit N2, X2	10 (5 pcs in kit)
Y2	-	393000K818	Seal kit Y2	10, 13, 14

See Customer Specification							
Code	Pos	Standard	A003 a)	A007 a)	A029 a)	Description	Remarks/Items
PA	76A, 76B	393000U052		393000U053		PLC053-025	4 [10]
PA	76A, 76B		398000K208			PLC053-032	4 [10]
PA	76A, 76B		398000K209			PLC053-040	4 [10]
PA	76A, 76B	393000K176	398000K301	393000K558		PLC053-050	4 [10]
PA	76A, 76B	393000K177		393000K559		PLC053-063	4 [10]
PA	76A, 76B	393000K178	398000K210	393000K560		PLC053-080	4 [10]
PA	76A, 76B	393000K179	398000K211	393000K561	398000K515	PLC053-100	4 [10]
PA	76A, 76B		398000K318			PLC053-120	4 [10]
PA	76A, 76B	393000K180	398000K271	393000K562		PLC053-125	4 [10]
PA	76A, 76B	393000K181		393000K563		PLC053-140	4 [10]
PA	76A, 76B	393000K182		393000K564	398000K516	PLC053-160	4 [10]
PA	76A, 76B		398000K319			PLC053-170	4 [10]
PA	76A, 76B	393000K183		393000K565		PLC053-175	4 [10]
PA	76A, 76B	393000K184		393000K566		PLC053-190	4 [10]
PA	76A, 76B	393000K185	398000K212	393000K567		PLC053-210	4 [10]
PA	76A, 76B	393000K186		393000K568		PLC053-230	4 [10]
PA	76A, 76B	393000K134		398000K249		PLC053-240	4 [10]
PA	76A, 76B	393000K187		393000K569	6760486	PLC053-250	4 [10]
PA	76A, 76B	393000K188		393000K570		PLC053-260	4 [10]
PA	76A, 76B	393000K189		393000K571		PLC053-280	4 [10]
PA	76A, 76B	393000K190		393000K572		PLC053-300	4 [10]
PA	76A, 76B	393000K191		393000K573		PLC053-320	4 [10]
PA	76A, 76B	393000K192		393000K574		PLC053-350	4 [10]

a) See position 89A and 89 B